

## Hygienic Butterfly Valve with BS4825 RJT Male Ends

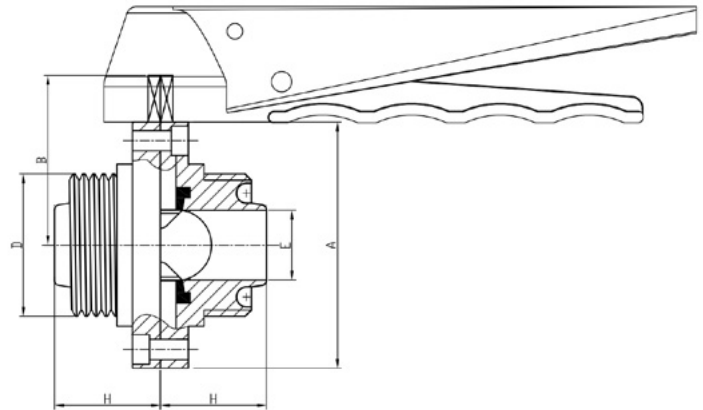

- F316L Stainless Steel body construction, F316L Stainless Steel Disc and Stem. FDA Food Grade EPDM Seal fitted as standard (FKM available).
- Stainless Steel Multi Position Lever (12 positions) with Locking facility.
- 145 psi (10 bar/g) pressure rated.
- -10 to +120 deg C max Temp.
- RJT Male x Male Ends to BS4825 (Male x Female available to order).
- CE marked in accordance with 2014/68/EU

A good all round, robust general purpose Hygienic Butterfly Valve. Compact and robust design. Can be fitted with our Stainless Steel Hygienic Cylinder style Actuators or our Electric or Pneumatic Rack and Pinion style Actuators, Positioners, Switch Boxes and Solenoids by using the custom "TSM" style Actuator Mounting Kit.

**EPDM Valve Seat conforms to FDA 177.2600 standards.**  
**0.8 Ra Polish on valve Disc and internal.**

**Available size range: 1" - 4"**

**3.1 Material Certificates available upon request**

Item	Part	Material	Qty.
1	Body	F316L	1
2	Disc	F316L	1
3	Seat	EPDM	1
4	Lever	304SS	1
5	Body Bolt	304SS	4

SIZE	A	B	D	E	H
1"	79	61	45.720x8TPI WHIT	22.1	34
1-1/2"	85	64.3	58.420x8TPI WHIT	34.8	38
2"	105	74.3	72.720x6TPI WHIT	47.5	40
2-1/2"	112	77.6	85.420x6TPI WHIT	60.2	40
3"	125	84.7	98.120x6TPI WHIT	73	41
4"	157	101.6	123.520x6TPI WHIT	97.6	50

SIZE	Torque*	ISO 5211	Stem Sq	Weight
1"	5.0 Nm	F04/F05	11mm	0.9Kg
1-1/2"	6.1 Nm	F04/F05	11mm	1.1Kg
2"	7.2 Nm	F04/F05	11mm	1.4Kg
2-1/2"	9.2 Nm	F04/F05	11mm	1.8Kg
3"	16 Nm	F04/F05	11mm	2.1Kg
4"	31 Nm	N/A	N/A	3.1Kg

**\*Torques based on Clean Water Duty  
 @ 5 bar/g without safety.**



### Mounting Kit

We offer this valve with a "TSM style Actuator Mounting Kit".



### Seals

We offer "spare seals" in EPDM and FKM (Viton ®).



### (Air/Spring) Actuator

The valve can be supplied with a "Hygienic Style" Stainless Steel Single Acting (Air/Spring) Actuator.

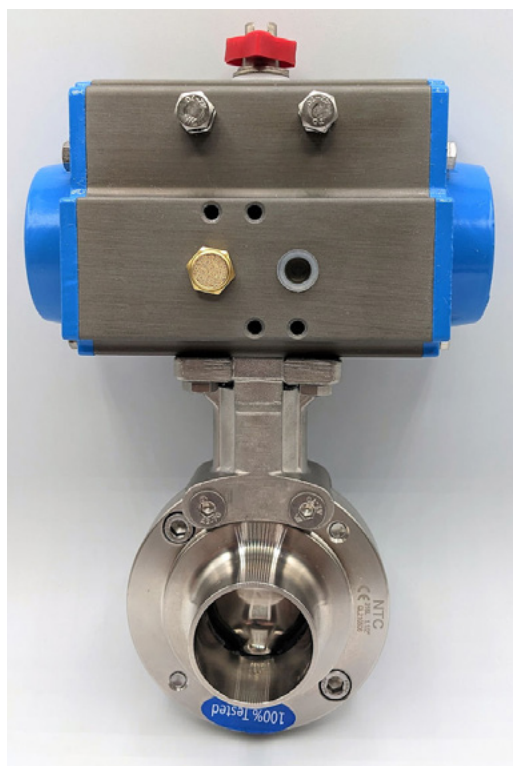

### "TSM" Style Actuator Mounting Kit

The "TSM" Mounting Kit allows virtually any type or make of Electric or Pneumatic Actuator to be mounted to our valve.