

Swing Pattern Check Valve Flanged BS4504 DIN PN16

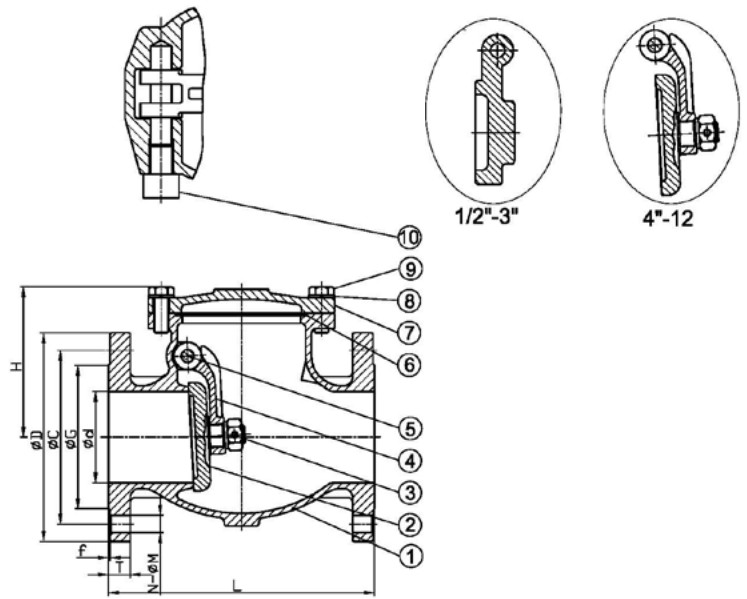

- ASTM A351 CF8M 316 Stainless Steel Body, Cover and Disc.
- 316 Stainless Steel Trim.
- PTFE Cover Seal. Bolted Cover design.
- Face to Face dimensions in accordance with DIN 3202/F1.
- 16 bar pressure rated.
- -20 / +200 Temp rated.
- Flanged DIN PN10/16 end connections.
- CE marked in accordance with the PED 2014/68/EU(from 1.1/4”).

Item	Part	Material	Qty.
1	Body	1.4408	1
2	Disc	1.4408	1
3	Nut	SUS304	1
4	Arm Hinge	1.4408	1
5	Hinge Pin	SUS316	1
6	Gasket	PTFE	1
7	Bonnet	1.4408	1
8	Spring Washers	SUS304	1
9	Bonnet Bolt	SUS304	1
10	Bolt	SUS304	1

This valve is a fully flanged unit that is designed to be bolted into the pipeline using flange connections. All of our DIN PN16 Flanged Gate, Globe, Check and Y-Strainer Valves conform to DIN 3202/F1 face to face dimensions which mean that they are “long pattern” valves and are not to be confused with shorter “ANSI” pattern valves that are available elsewhere.

Test standard – API 598

Available size range: 1/2” - 8”

SIZE	d	L	H	D	C	G	f	T	N-M
1/2”	15	130	51	95	65	45	2	14	4-14
3/4”	20	150	54	105	75	58	2	16	4-14
1”	25	160	64	115	85	68	2	16	4-14
1-1/4”	32	180	68	140	100	78	2	16	4-18
1-1/2”	40	200	75	150	110	88	3	16	4-18
2”	50	230	97	165	125	102	3	18	4-18
2-1/2”	65	290	111	185	145	122	3	18	4-18
3”	80	310	120	200	160	138	3	20	8-18
4”	100	350	162	220	180	158	3	20	8-18
5”	125	400	179	250	210	188	3	22	8-18
6”	150	480	203	285	240	212	3	22	8-22
8”	200	600	236	340	295	268	3	24	12-22

Pressure-Temp. Rating

