

Installation, Operating and Maintenance Instructions for Wafer Swing Check valve

Type: ETG WPSCV16

1. Application

The valve is suitable to be used as a one-way go through and non-return device on pipeline systems.

2. Features

2.1 The valve is designed as a soft seat, which helps to prevent any backflow.

2.2 The valve is connected by wafer flanged ends to slot between flanges, the assembly length is minimal.

2.3 The valve offers stable performance and can be used for a long period.

3. Standards

3.1 Flange End: DIN PN16, ANSI 150#

3.2 Test according to EN12226-1, API598

4. Performance Specification

4.1 Size: DN32~ DN300

4.2 Pressure rating: PN16(150#)

4.3 Working temperature: -25°C~ 180°C

5. Material of main parts

Please check suitability of product media before installation, eg. Corrosive data, temperature ratings, pressure ratings, etc.

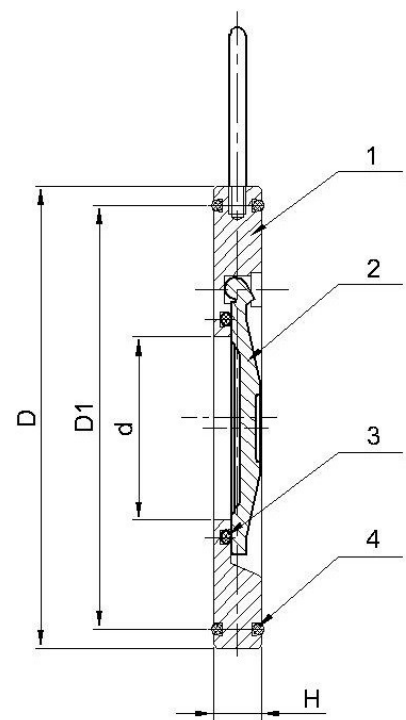
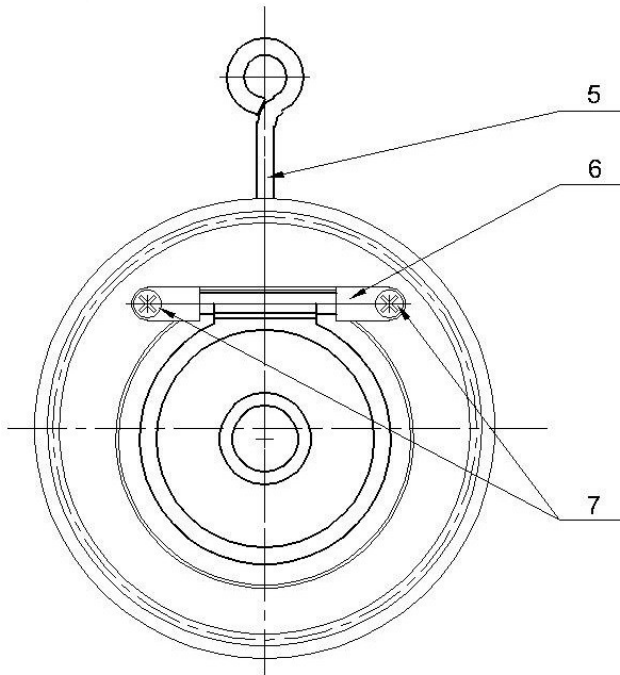

ITEM	PART	MATERIAL	QTY.
1	Body	CF8M	1
3	Disk	CF8M	1
5	Disk O-ring	Viton	1
4	External O-ring	Viton	3
5	Hook	SS304	1
6	Stem Stopper	SS316	3
7	Axis Screw	SS316	3

6. Installation

6.1 Check the interior channels of the pipe and valve before assembly. If the interior channels are not clean, flush them with clean water before installation of the valve.

6.2 Use the valves at correct pressures and temperatures according to the rates shown.

6.3 Install the valve using the correct flanges within the piping system. Gaskets should not be used as the seals on the valve ensure no leakage. Ensure the outer circle of valve is concentric with the flanges outer circle and PCD whilst connecting.

6.4 Please observe the directional arrow shown on the valve body. This shows the direction in which the media flow is expected to run. The reverse is non-return. Install the valves correctly in order to avoid damage to the valve and any other connecting products.

7. Maintenance

7.1 Dis-assembly

7.1.1 Loosen and remove the bolts in order to take out the valve from the pipework.

7.1.2 Loosen the axis thread. Take out the stem stopper, the disc and O-rings.

7.2 Clean all metal parts with clean water and a soft brush. Clean O-rings in clean water. Check all parts, especially the O-rings. Replace any parts if necessary.

7.3 Assembly of the valve is the reverse of the above.