

Socket Weld 150# Range

K-01B Elbow 90 Equal Banded Socket Weld

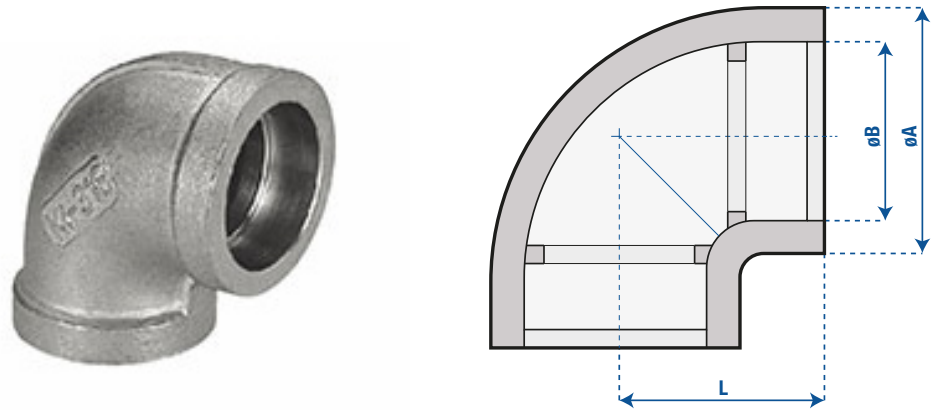

SIZE	øA	øB	L
1/2"	29	22	27
3/4"	36	27.4	33
1"	43	34.1	38
1-1/4"	52	42.9	45
1-1/2"	58.5	48.9	50
2"	71.5	61.4	57
2-1/2"	87	74.4	69.7
3"	99.5	90.1	77
4"	126	115.7	98.2

K-02B Tee Banded Socket Weld

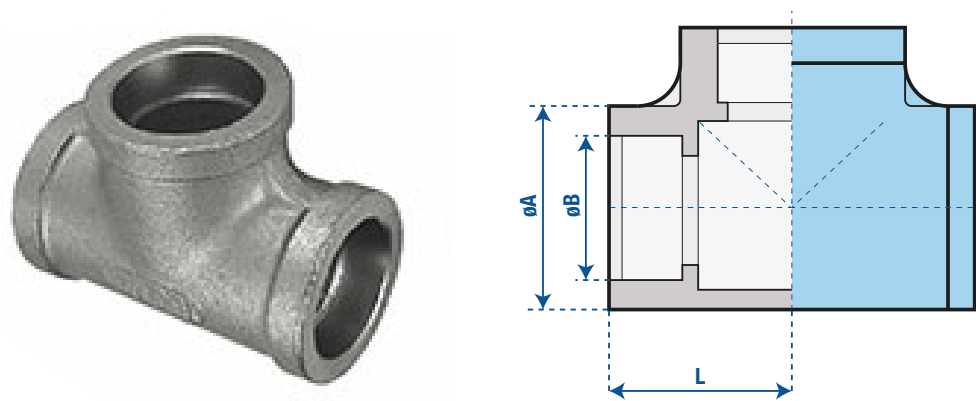

SIZE	øA	øB	L
1/2"	30	22	28
3/4"	35	27.4	33
1"	43	34.1	38
1-1/4"	52	42.9	45
1-1/2"	58.5	48.9	50
2"	71.5	61.4	58
2-1/2"	87	74.1	70
3"	100	90.1	78.5
4"	125	115.7	97

K-5A Elbow 45 Banded Socket Weld

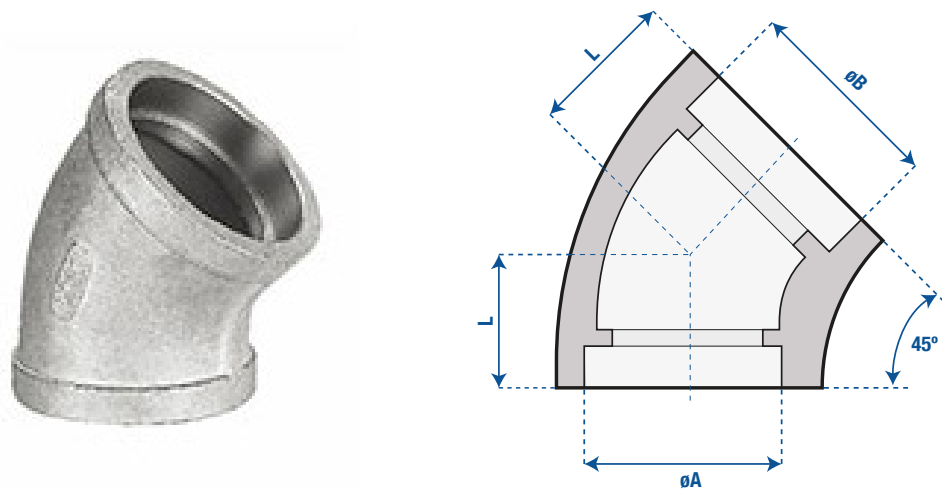

SIZE	øA	øB	L
1/2"	30.8	22	22
3/4"	37.5	27.4	25.6
1"	45.3	34.1	28.4
1-1/4"	55	42.9	33.4
1-1/2"	62	48.9	36.4
2"	75.6	61.4	42.9

Socket Weld 150# Range

K-06R

Union Conical Joint Socket Weld

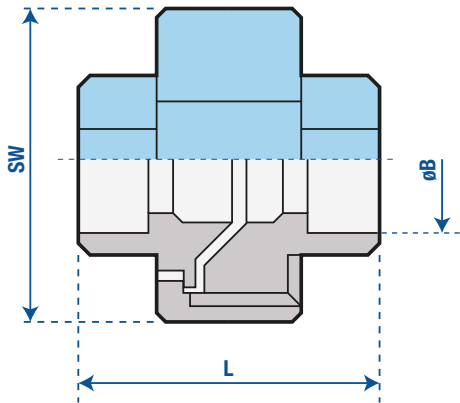

SIZE	øB	L	SW
1/2"	22	42	42
3/4"	27.4	50.4	47
1"	34.1	48	53
1-1/4"	42.9	59	71
1-1/2"	48.9	65	78
2"	61.4	69	92
2-1/2"	74.4	80	112
3"	90.1	88	127
4"	115.7	108	157

K-12D

Full Socket (Coupling) Socket Weld

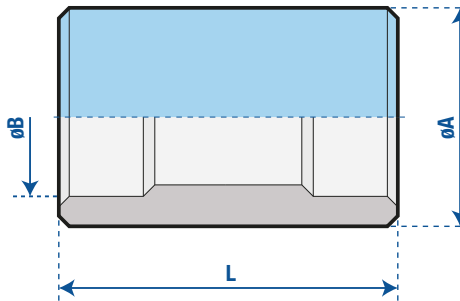

SIZE	øA	øB	L
1/2"	26.7	22	34
3/4"	32	27.4	36
1"	40	34.1	43
1-1/4"	48.3	42.9	48
1-1/2"	55.1	48.9	48
2"	66.2	61.4	56
2-1/2"	84.6	74.1	73.2
3"	95	90.1	71
4"	122	115.7	83

K-06D

Union Conical Joint Butt Weld

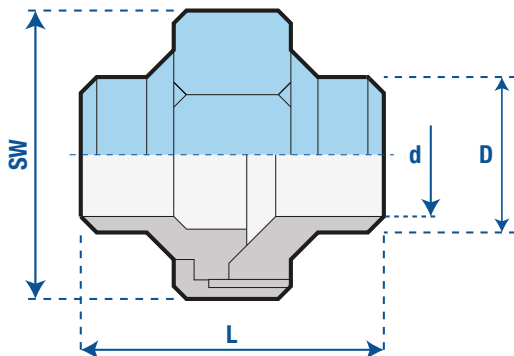

SIZE	L	SW	D	d
1/2"	42	42	21.3	16.7
3/4"	50.4	47	26.9	21.5
1"	48	53	33.7	26.5
1-1/4"	59	71	42.4	35.8
1-1/2"	64	78	48.3	42
2"	69	92	60.3	53.3