

Sanitary/Hygienic Sample Tap ETG SV-1

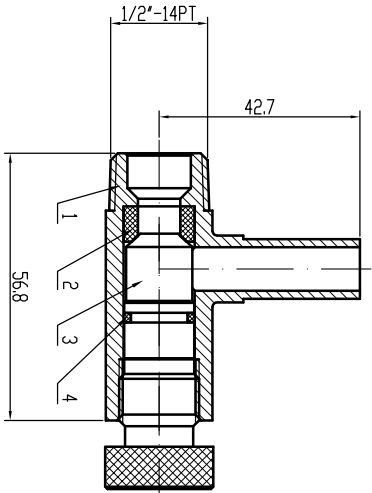

- Mirror Polished ASTM A351 CF8M 316 Stainless Steel Construction.
- EPDM Body and Seat gasket.
- PTFE Seats and NBR ‘O’Ring.
- 1/2” BSPT Male Inlet Connection with 12.7mm (1/2” O/D) Spout.
- Stainless Steel “Knurled” Operating Knob

A cost effective, simple solution for Process Sampling where Hygiene or Aseptic properties are non essential.



Item	Part	Material	Qty.
1	Body	CF8M	1
2	Body Seat	PTFE	1
3	Valve Plug	316	1
4	O-Ring	NBR	1